

Pipe / duct laid to fall (if required)
& surrounded in suitable granular material

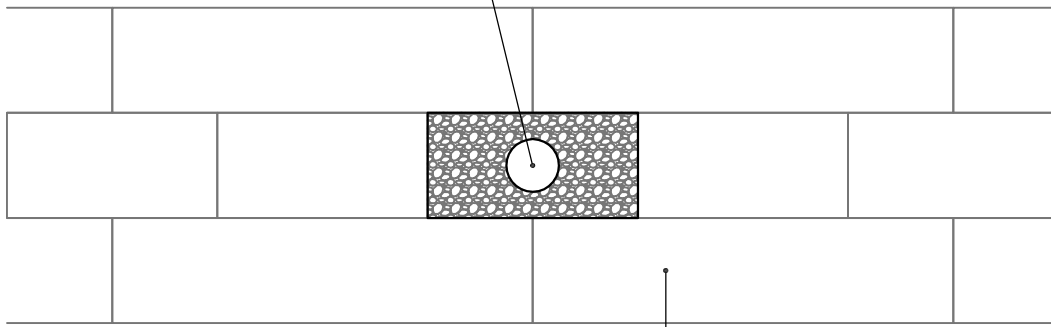

HORIZONTAL PENETRATION
DETAIL

Filcor

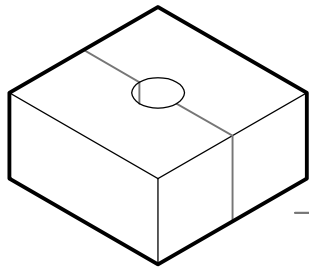

PIPE COLLAR ISOMETRIC
VIEW

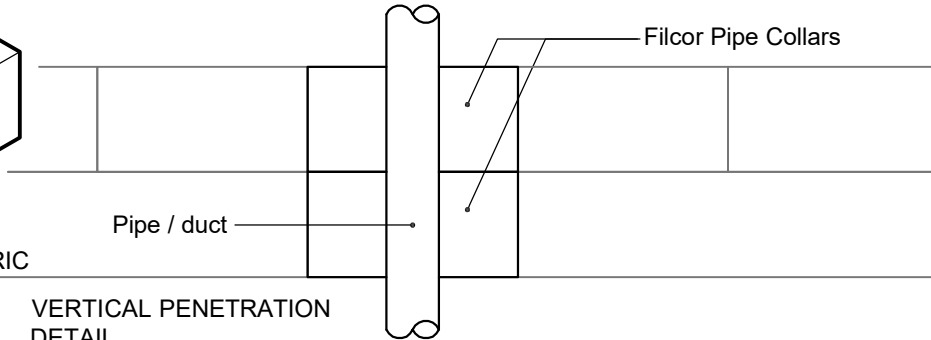

VERTICAL PENETRATION
DETAIL

Filcor Pipe Collars

Pipe / duct

Filcor Grades & Physical Properties

Grade	Maximum recommended load kN/m ² *	Nominal density Kg/m ³
Filcor 20	20	15
Filcor 45	45	20
Filcor 70	70	25
Filcor 90	90	30
Filcor 100	100	35
Filcor 120	120	40
Filcor 140	140	45
Filcor 160	160	50
Filcor 190	190	55

All Filcor grades of expanded polystyrene are manufactured in accordance with BS EN 14933:2007

* Maximum recommended load to not exceed theoretical compressive strength at 1% strain

Standard Detail



Tel : 01403 799600
Email : techsupport@cordek.com

Drg. Title:
Standard Pipe / Duct Penetration Detail - Filcor

Drawn: SJP

Date: Nov.2019

Scale: NTS

Drg No. ENG/SF/FIL/007

Rev. 1

Products :-

Filcor.

Notes :-

- All Filcor material is manufactured in accordance with EN 14933:2007.
- The Filcor material should be supported on a firm, level surface.
- If the applied load exceeds the theoretical compressive strength at 1% strain then the strain will potentially exceed 1% (the assumed elastic limit) and the amount of deflection should be considered.
- Where the depth of Filcor requires multiple layers, each subsequent layer should be laid perpendicular to the one below, with all joints equally staggered.
- Use of the Puraflex VOC Membrane to provide VOC / Hydrocarbon protection to the Filcor installation should be considered where deemed appropriate.
- This detail is issued for guidance only, with final approval required by the designer.